

Short Recessed Panel

3 LAYER SANDWICH

3620

Insulated Sandwich

doorLink
MANUFACTURING, INC.®

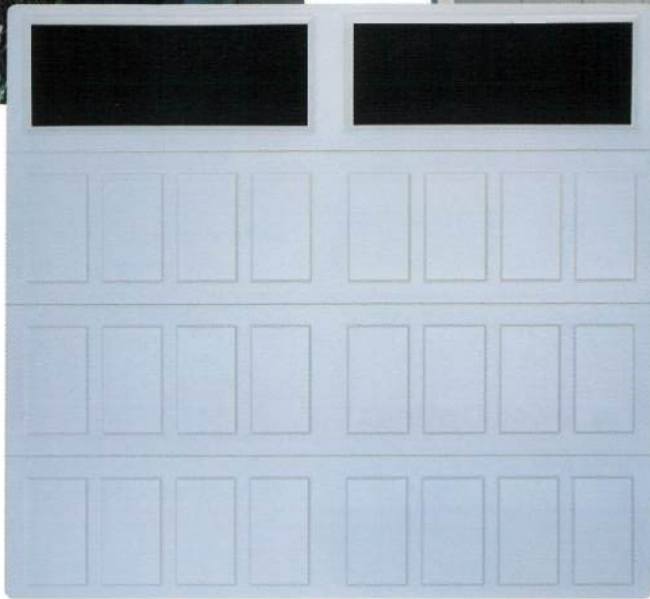

WHITE

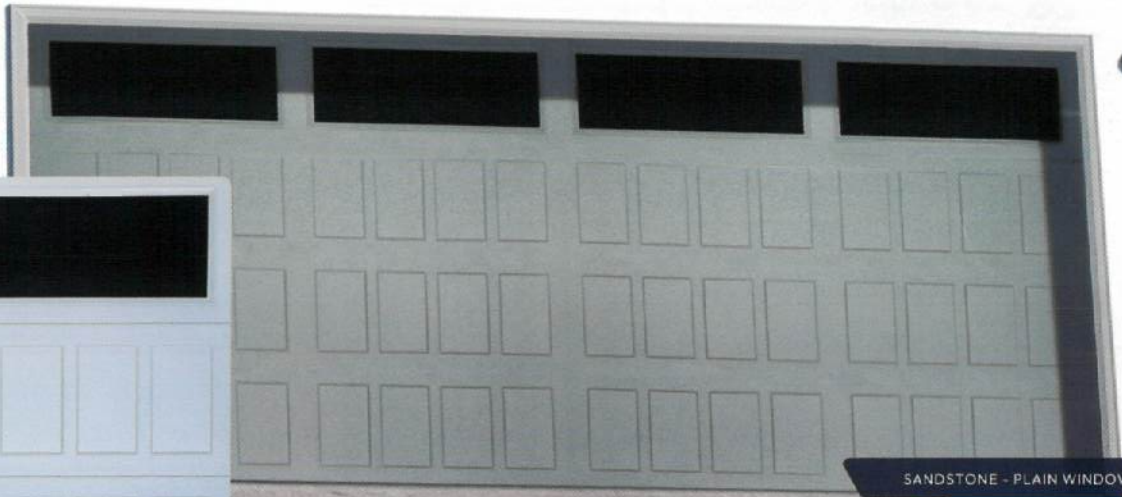

SANDSTONE - PLAIN WINDOW

3620

Short Recessed Panel

2" thick insulated steel sandwich panel constructed of top quality materials. Highly detailed short recessed panel, deep pebble grain texture, and two coat prefinished paint system all combine to enhance the beauty of your home.

- ◆ 2" thick insulated 3 layer sandwich panel
- ◆ 1.0 mil paint with 12 color options
- ◆ 6 window options
- ◆ R-value 10.25
- ◆ Steel interior skin

*Colors may vary from actual product

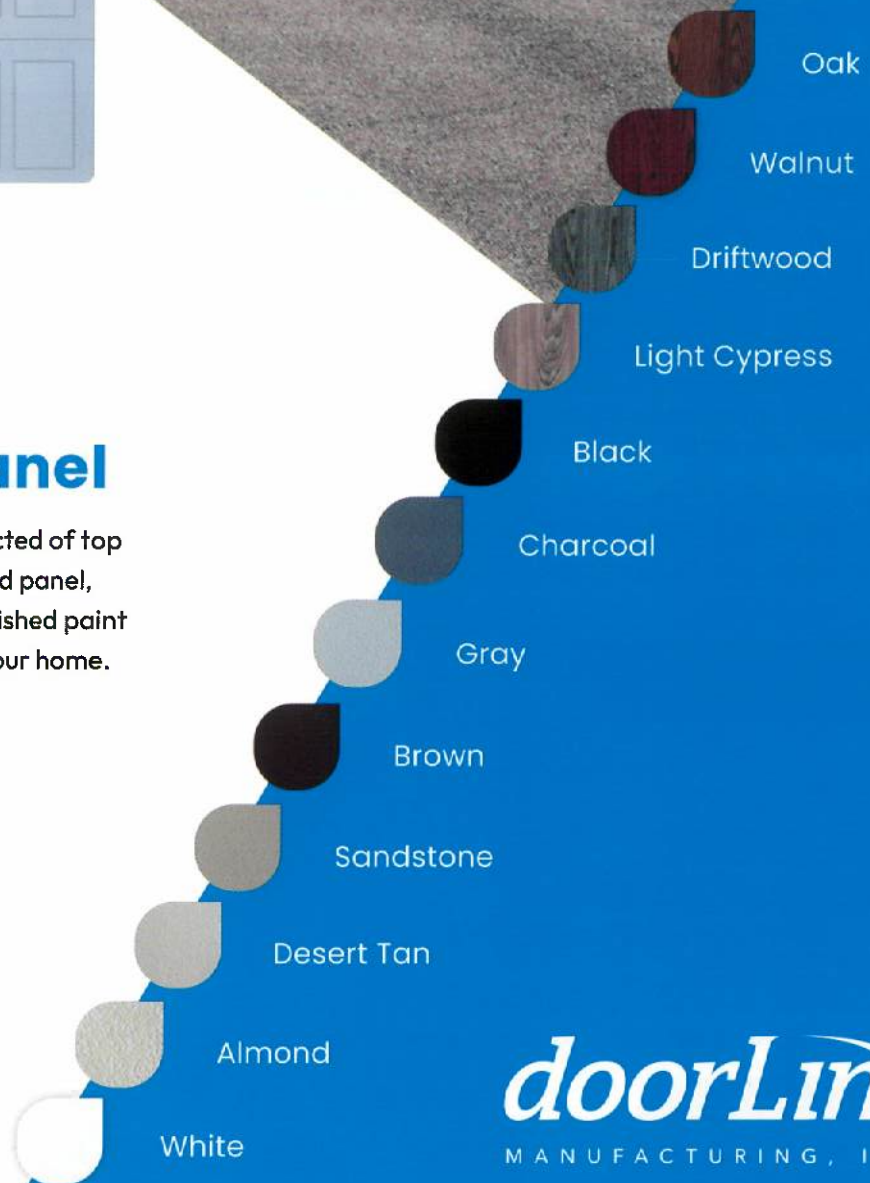

doorLink
MANUFACTURING, INC.®

3620 | Short Recessed Panel

Insulated Sandwich

3 LAYER SANDWICH

Features

26 26 GAUGE STEEL

Hot dipped galvanized steel construction with hemmed inside return rail provides superior strength and durability.

20 GAUGE HOT DIPPED STEEL HINGE PLATES

Galvanized steel hinge plates run the full height of each section at all hinge locations to facilitate the attachment of hinges, handles, struts, and step plates.

TONGUE AND GROOVE MEETING RAILS

For superior strength and better sealing against wind, rain, and snow.

DIRECTIONAL WOOD GRAIN PATTERN

Directional wood grain pattern gives the appearance of traditional wood doors.

RIGID ALUMINUM RETAINER WITH WEATHERSTRIP

Provides added strength while securing replaceable U-type bottom astragal weatherstrip to help keep the elements out.

R-VALUE 10.25

Sandwich type construction with polystyrene insulation pressure bonded between two sheets of hot dipped galvanized steel enhances your home's energy savings, makes your door operation quieter, and reduces exterior noise in your garage.

CFC FREE EXPANDED POLYSTYRENE

Environmentally friendly insulation that will not degrade with vibration or time.

Window Options

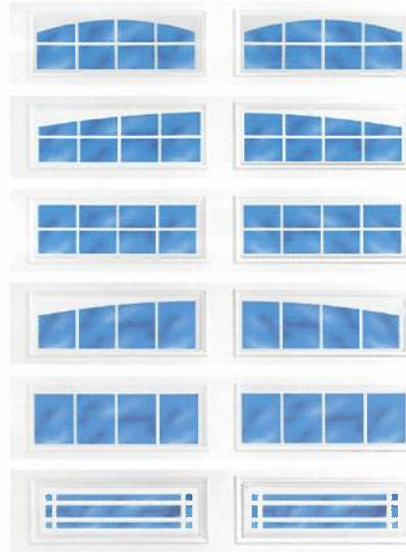

#287 Stockton Arch

#388 Somerton

#387 Stockton

#588 Wyndbridge

#587 Stockbridge

#897 Prairie

Window Glass Options

See website for glass options

*Not all glazing options may be available from all distributors. No glazing on 18" sections. Not all window inserts align with panel stamp design.

Paint System



1.0 MIL PAINT SYSTEM

Includes .25 mil rust inhibiting primer and .75 mil exterior top coat that resists fading and chalking, while providing consistent color from panel to panel and more durability.

- 1 Paint - .75 MIL
- 2 Primer - .25 MIL
- 3 Steel
- 4 Primer - .2 MIL
- 5 Paint - .3 MIL

Size Options

WIDTHS:



HEIGHT: 6'6", 6'9", 7'0", 7'6", 7'9", 8'0" *Contact your distributor for additional heights.

Construction

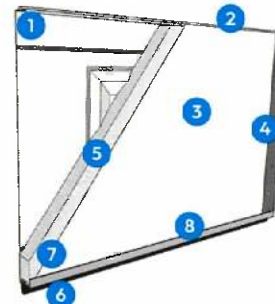

- 1 Tongue and groove meeting rails
- 2 2" thick section
- 3 Pebble grain embossed interior backskin
- 4 20 gauge hot dipped galvanized steel end caps
- 5 CFC free expanded polystyrene insulation
- 6 Replaceable U-Type vinyl bottom weatherstrip
- 7 20 gauge full vertical steel hinge plate for hardware attachment
- 8 Extruded aluminum weatherstrip retainer

3630

INSULATED SANDWICH

doorLink
Manufacturing, Inc.®

Grooved Panel 3 Layer Sandwich

CARRIAGE HOUSE PANELS



ALMOND | STOCKTON WINDOW



WHITE | STOCKTON WINDOW

Grooved Panel

2" thick insulated steel sandwich panel constructed of top quality materials. Highly detailed grooved panel, deep pebble grain texture, and two coat prefinished paint system all combine to enhance the beauty of your home.

- 2" thick insulated 3 layer sandwich panel
- 1.0 mil paint with 10 color options
- 6 window options
- R-value 10.25
- Steel interior skin



WHITE



ALMOND



DESERT TAN



SANDSTONE



BROWN



GRAY



BLACK



OAK



WALNUT



DRIFTWOOD

**Colors may vary from actual product*

FEATURES



26 GAUGE STEEL

Hot dipped galvanized steel construction with hemmed inside return rail provides superior strength and durability.



20 GAUGE HOT DIPPED STEEL HINGE PLATES

Galvanized steel hinge plates run the full height of each section at all hinge locations to facilitate the attachment of hinges, handles, struts, and step plates.



TONGUE AND GROOVE MEETING RAILS

For superior strength and better sealing against wind, rain, and snow.



DIRECTIONAL WOOD GRAIN PATTERN

Directional wood grain pattern gives the appearance of traditional wood doors.



RIGID ALUMINUM RETAINER WITH WEATHERSTRIP

Provides added strength while securing replaceable U-type bottom astragal weatherstrip to help keep the elements out.



R-VALUE 10.25

Sandwich type construction with polystyrene insulation pressure bonded between two sheets of hot dipped galvanized steel enhances your home's energy savings, makes your door operation quieter, and reduces exterior noise in your garage.



CFC FREE EXPANDED POLYSTYRENE

Environmentally friendly insulation that will not degrade with vibration or time.

SIZE OPTIONS

WIDTHS:



HEIGHTS: 6'6", 6'9", 7'0", 7'6", 7'9", 8'0"

WINDOW OPTIONS



#287
Stockton Arch



#388
Somerton



#387
Stockton



#588
Wyndbridge



#587
Stockbridge



#897
Prairie

WINDOW GLASS OPTIONS

See website for glass options

**Not all glazing options may be available from all distributors. No glazing on 18" sections.*

PAINT LAYERS

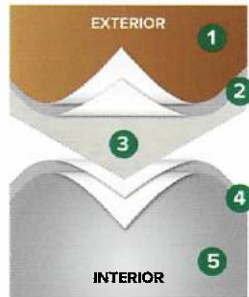

1.0 MIL PAINT SYSTEM

Includes .25 mil rust inhibiting primer and .75 mil exterior top coat that resists fading and chalking, while providing consistent color from panel to panel and more durability.

- 1 Paint - .75 MIL
- 2 Primer - .25 MIL
- 3 Steel
- 4 Primer - .2 MIL
- 5 Paint - .3 MIL

CONSTRUCTION

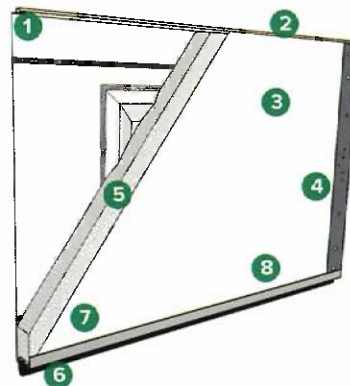

- 1 Tongue and groove meeting rails
- 2 2" thick section
- 3 Pebble grain embossed interior backskin
- 4 20 gauge hot dipped galvanized steel end caps
- 5 CFC free expanded polystyrene insulation
- 6 Replaceable U-Type vinyl bottom weatherstrip
- 7 20 gauge full vertical steel hinge plate for hardware attachment
- 8 Extruded aluminum weatherstrip retainer



WHITE

3640

Long Grooved Panel

2" thick insulated steel sandwich panel constructed of top quality materials. Highly detailed long grooved panel, deep pebble grain texture, and two coat prefinished paint system all combine to enhance the beauty of your home.

- ◆ 2" thick insulated 3 layer sandwich panel
- ◆ 1.0 mil paint with 12 color options
- ◆ 6 window options
- ◆ R-value 10.25
- ◆ Steel interior skin

*Colors may vary from actual product

WALNUT - NO WINDOW

- Oak
- Walnut
- Driftwood
- Light Cypress
- Black
- Charcoal
- Gray
- Brown
- Sandstone
- Desert Tan
- Almond
- White

doorLink
MANUFACTURING, INC.®

3640 | Long Grooved Panel

Insulated Sandwich

3 LAYER SANDWICH

Carriage House Panels

Features

26 26 GAUGE STEEL
Hot dipped galvanized steel construction with hemmed inside return rail provides superior strength and durability.

20 GAUGE HOT DIPPED STEEL HINGE PLATES
Galvanized steel hinge plates run the full height of each section at all hinge locations to facilitate the attachment of hinges, handles, struts, and step plates.

TONGUE AND GROOVE MEETING RAILS
For superior strength and better sealing against wind, rain, and snow.

DIRECTIONAL WOOD GRAIN PATTERN
Directional wood grain pattern gives the appearance of traditional wood doors.

RIGID ALUMINUM RETAINER WITH WEATHERSTRIP
Provides added strength while securing replaceable U-type bottom astragal weatherstrip to help keep the elements out.

R-VALUE 10.25
Sandwich type construction with polystyrene insulation pressure bonded between two sheets of hot dipped galvanized steel enhances your home's energy savings, makes your door operation quieter, and reduces exterior noise in your garage.

CFC FREE EXPANDED POLYSTYRENE
Environmentally friendly insulation that will not degrade with vibration or time.

Size Options

WIDTHS:

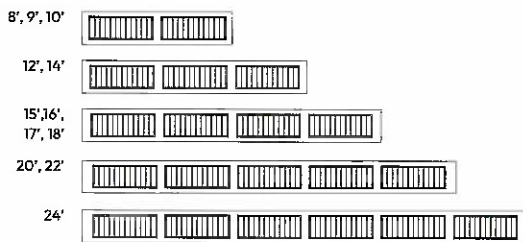

HEIGHT: 6'6", 6'9", 7'0", 7'6", 7'9", 8'0" *Contact your distributor for additional heights.

Window Options

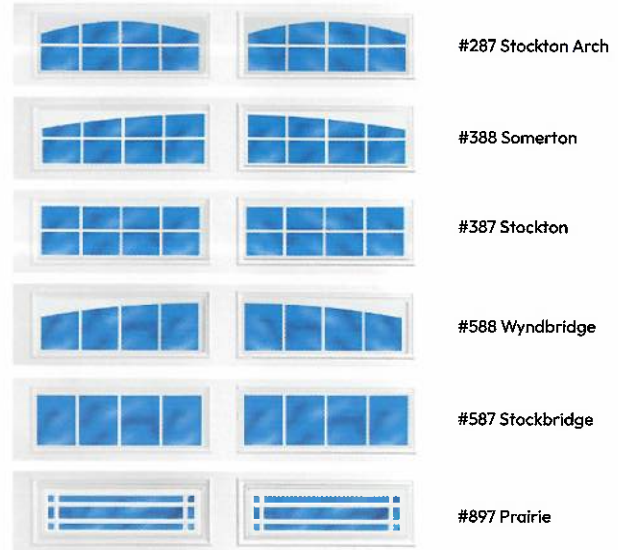

Window Glass Options

See website for glass options

*Not all glazing options may be available from all distributors. No glazing on 18" sections.

Paint System



1.0 MIL PAINT SYSTEM

Includes .25 mil rust inhibiting primer and .75 mil exterior top coat that resists fading and chalking, while providing consistent color from panel to panel and more durability.

- 1 Paint - .75 MIL
- 2 Primer - .25 MIL
- 3 Steel
- 4 Primer - .2 MIL
- 5 Paint - .3 MIL

Construction

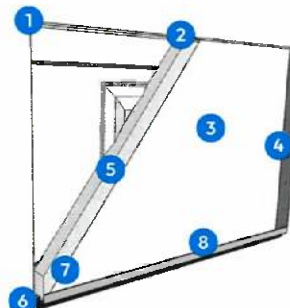

- 1 Tongue and groove meeting rails
- 2 2" thick section
- 3 Pebble grain embossed interior backskin
- 4 20 gauge hot dipped galvanized steel end caps
- 5 CFC free expanded polystyrene insulation
- 6 Replaceable U-Type vinyl bottom weatherstrip
- 7 20 gauge full vertical steel hinge plate for hardware attachment
- 8 Extruded aluminum weatherstrip retainer

Flush Panel

3 LAYER SANDWICH

3650

Insulated Sandwich

doorLink

MANUFACTURING, INC.®

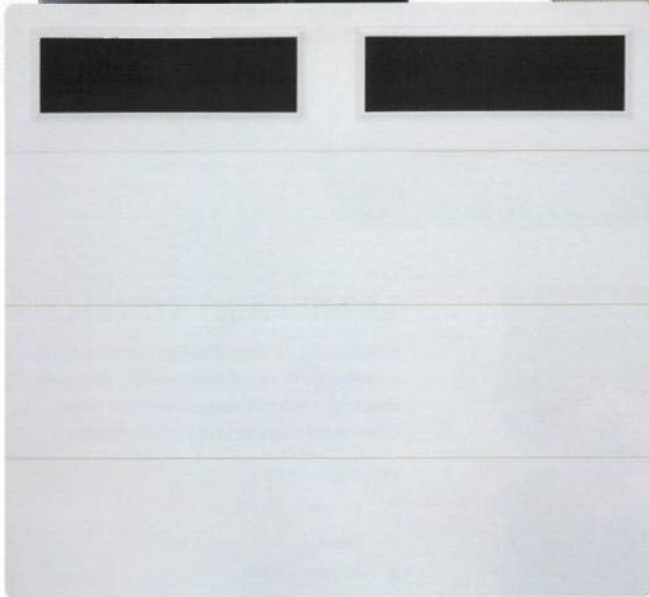

WHITE

3650 Flush Panel

2" thick insulated steel sandwich panel constructed of top quality materials. Flush panel with deep woodgrain texture and two coat prefinished paint system all combine to enhance the beauty of your home.

- ◆ 2" thick insulated 3 layer sandwich panel
- ◆ 1.0 mil paint with 8 color options
- ◆ R-value 10.25
- ◆ Steel interior skin

*Colors may vary from actual product

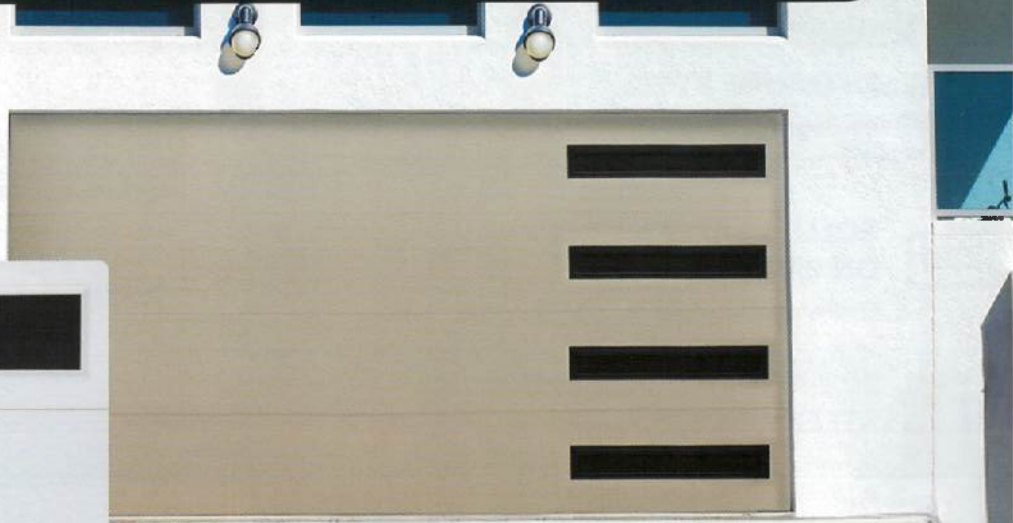

SANDSTONE - CONTEMPORARY WINDOW



doorLink

MANUFACTURING, INC.®

3650 | Flush Panel

Insulated Sandwich

3 LAYER SANDWICH

Features

26 26 GAUGE STEEL

Hot dipped galvanized steel construction with hemmed inside return rail provides superior strength and durability.

ROLLED SAFETY EDGES ON SECTION JOINTS

Eliminates sharp edges, and provides extra strength.

20 GAUGE HOT DIPPED STEEL HINGE PLATES

Galvanized steel hinge plates run the full height of each section at all hinge locations to facilitate the attachment of hinges, handles, struts, and step plates.

TONGUE AND GROOVE MEETING RAILS

For superior strength and better sealing against wind, rain, and snow.

RIGID ALUMINUM RETAINER WITH WEATHERSTRIP

Provides added strength while securing replaceable U-type bottom astragal weatherstrip to help keep the elements out.

R-VALUE 10.25

Sandwich type construction with polystyrene insulation pressure bonded between two sheets of hot dipped galvanized steel enhances your home's energy savings, makes your door operation quieter, and reduces exterior noise in your garage.

CFC FREE EXPANDED POLYSTYRENE

Environmentally friendly insulation that will not degrade with vibration or time.

Size Options

WIDTHS: 8', 9', 10', 12', 14', 15', 16', 17', 18', 14', 20', 22'

HEIGHTS: 6'6", 6'9", 7'0", 7'6", 7'9", 8'0"

*Contact your distributor for additional heights

Window Options



Contemporary Window

41" X 7"

Check with your supplier for additional window options.

Paint System



1.0 MIL PAINT SYSTEM

Includes .25 mil rust inhibiting primer and .75 mil exterior top coat that resists fading and chalking, while providing consistent color from panel to panel and more durability.

- 1 Paint - .75 MIL
- 2 Primer - .25 MIL
- 3 Steel
- 4 Primer - .2 MIL
- 5 Paint - .3 MIL

Construction

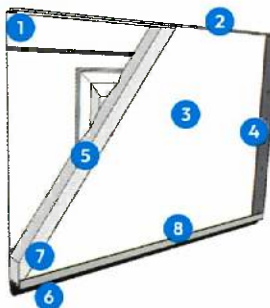

- 1 Tongue and groove meeting rails
- 2 2" thick section
- 3 Pebble grain embossed interior backskin
- 4 20 gauge hot dipped galvanized steel end caps
- 5 CFC free expanded polystyrene insulation
- 6 Replaceable U-Type vinyl bottom weatherstrip
- 7 20 gauge full vertical steel hinge plate for hardware attachment
- 8 Extruded aluminum weatherstrip retainer

Long Recessed Panel

3 LAYER SANDWICH

3680

Insulated Sandwich

doorLink
MANUFACTURING, INC.®

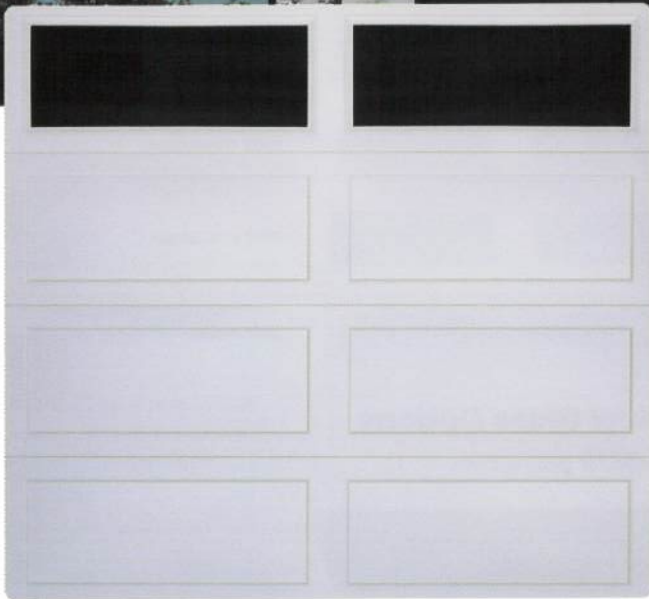

WHITE

3680

Long Recessed Panel

2" thick insulated steel sandwich panel constructed of top quality materials. Highly detailed long recessed panel, deep pebble grain texture, and two coat prefinished paint system all combine to enhance the beauty of your home.

- ◆ 2" thick insulated 3 layer sandwich panel
- ◆ 1.0 mil paint with 12 color options
- ◆ 6 window options
- ◆ R-value 10.25
- ◆ Steel interior skin

*Colors may vary from actual product



BLACK - PLAIN WINDOW

- Oak
- Walnut
- Driftwood
- Light Cypress
- Black
- Charcoal
- Gray
- Brown
- Sandstone
- Desert Tan
- Almond
- White

doorLink
MANUFACTURING, INC.®

3680 | Long Recessed Panel

Insulated Sandwich

3 LAYER SANDWICH

Features

26 26 GAUGE STEEL

Hot dipped galvanized steel construction with hemmed inside return rail provides superior strength and durability.

20 GAUGE HOT DIPPED STEEL HINGE PLATES

Galvanized steel hinge plates run the full height of each section at all hinge locations to facilitate the attachment of hinges, handles, struts, and step plates.

TONGUE AND GROOVE MEETING RAILS

For superior strength and better sealing against wind, rain, and snow.

DIRECTIONAL WOOD GRAIN PATTERN

Directional wood grain pattern gives the appearance of traditional wood doors.

RIGID ALUMINUM RETAINER WITH WEATHERSTRIP

Provides added strength while securing replaceable U-type bottom astragal weatherstrip to help keep the elements out.

R-VALUE 10.25

Sandwich type construction with polystyrene insulation pressure bonded between two sheets of hot dipped galvanized steel enhances your home's energy savings, makes your door operation quieter, and reduces exterior noise in your garage.

CFC FREE EXPANDED POLYSTYRENE

Environmentally friendly insulation that will not degrade with vibration or time.

Window Options

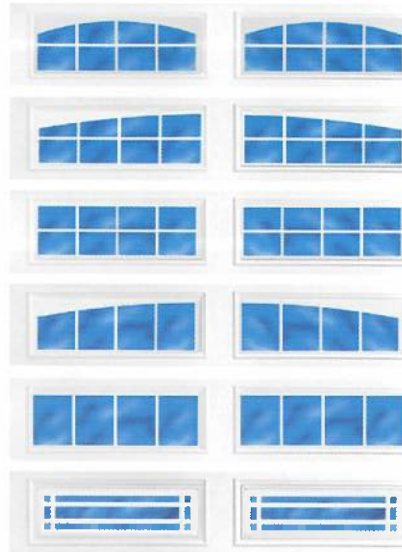

#287 Stockton Arch

#388 Somerton

#387 Stockton

#588 Wyndbridge

#587 Stockbridge

#897 Prairie

Window Glass Options

See website for glass options

*Not all glazing options may be available from all distributors.
No glazing on 18" sections.

Size Options

WIDTHS:

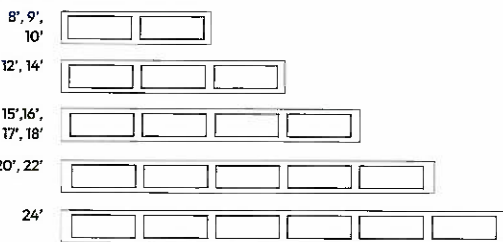

HEIGHT: 6'6", 6'9", 7'0", 7'6", 7'9", 8'0" *Contact your distributor for additional heights.

Paint System



1.0 MIL PAINT SYSTEM

Includes .25 mil rust inhibiting primer and .75 mil exterior top coat that resists fading and chalking, while providing consistent color from panel to panel and more durability.

- 1 Paint - .75 MIL
- 2 Primer - .25 MIL
- 3 Steel
- 4 Primer - .2 MIL
- 5 Paint - .3 MIL

Construction

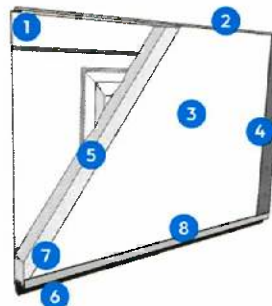

- 1 Tongue and groove meeting rails
- 2 2" thick section
- 3 Pebble grain embossed interior backskin
- 4 20 gauge hot dipped galvanized steel end caps
- 5 CFC free expanded polystyrene insulation
- 6 Replaceable U-Type vinyl bottom weatherstrip
- 7 20 gauge full vertical steel hinge plate for hardware attachment
- 8 Extruded aluminum weatherstrip retainer



WHITE



CHARCOAL - STOCKTON WINDOW

3690

Raised Ranch Panel

2" thick insulated steel sandwich panel constructed of top quality materials. Highly detailed raised ranch panel, deep woodgrain texture, and two coat prefinished paint system all combine to enhance the beauty of your home.

- ◆ 2" thick insulated 3 layer sandwich panel
- ◆ 1.0 mil paint with 8 color options
- ◆ 6 window options
- ◆ R-value 10.25
- ◆ Steel interior skin

*Colors may vary from actual product

Black

Charcoal

Gray

Brown

Sandstone

Desert Tan

Almond

White

doorLink
MANUFACTURING, INC.®

3690 | Raised Ranch Panel

Insulated Sandwich

3 LAYER SANDWICH

Features



26 GAUGE STEEL

Hot dipped galvanized steel construction with hemmed inside return rail provides superior strength and durability.



20 GAUGE HOT DIPPED STEEL HINGE PLATES

Galvanized steel hinge plates run the full height of each section at all hinge locations to facilitate the attachment of hinges, handles, struts, and step plates.



TONGUE AND GROOVE MEETING RAILS

For superior strength and better sealing against wind, rain, and snow.



RIGID ALUMINUM RETAINER WITH WEATHERSTRIP

Provides added strength while securing replaceable U-type bottom astragal weatherstrip to help keep the elements out.



R-VALUE 10.25

Sandwich type construction with polystyrene insulation pressure bonded between two sheets of hot dipped galvanized steel enhances your home's energy savings, makes your door operation quieter, and reduces exterior noise in your garage.



CFC FREE EXPANDED POLYSTYRENE

Environmentally friendly insulation that will not degrade with vibration or time.

Size Options

WIDTHS:

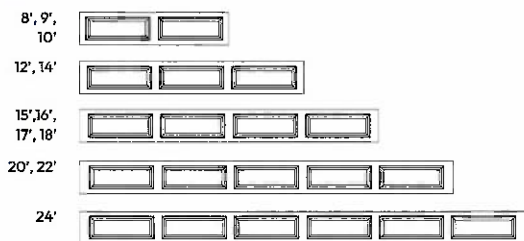

HEIGHT: 6'6", 6'9", 7'0", 7'6", 7'9", 8'0" *Contact your distributor for additional heights.

Window Options



#306 Sherwood



#305 Williamsburg



#591 Cascade



#397 Stockton



#597 Stockbridge



#897 Prairie

Window Glass Options

See website for glass options

*Not all glazing options may be available from all distributors.
No glazing on 18" sections

Paint System



1.0 MIL PAINT SYSTEM

Includes .25 mil rust inhibiting primer and .75 mil exterior top coat that resists fading and chalking, while providing consistent color from panel to panel and more durability.

- 1 Paint - .75 MIL
- 2 Primer - .25 MIL
- 3 Steel
- 4 Primer - .2 MIL
- 5 Paint - .3 MIL

Construction

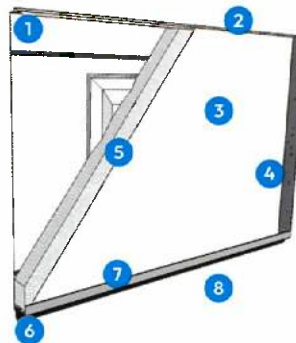

- 1 Tongue and groove meeting rails
- 2 2" thick section
- 3 Pebble grain embossed interior backskin
- 4 20 gauge hot dipped galvanized steel end caps
- 5 CFC free expanded polystyrene insulation
- 6 Replaceable U-Type vinyl bottom weatherstrip
- 7 20 gauge full vertical steel hinge plate for hardware attachment
- 8 Extruded aluminum weatherstrip retainer

**Traditional
Raised Panel**
24 GAUGE

410/411
Non-Insulated Insulated

doorLink
MANUFACTURING, INC.®

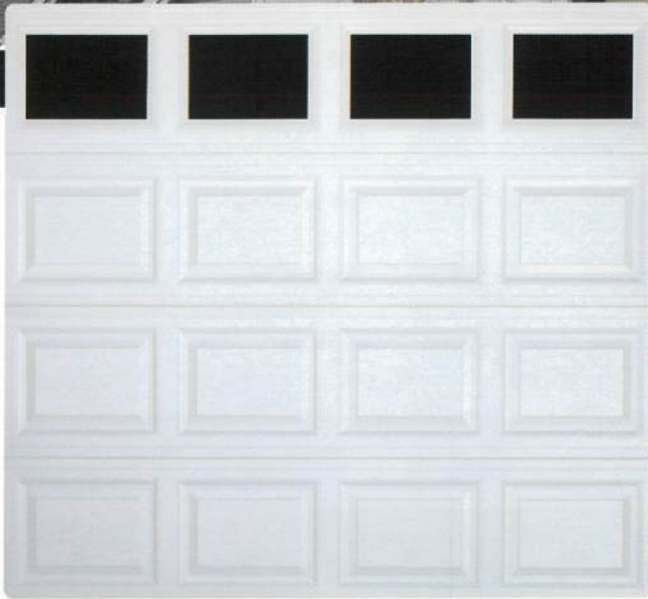

WHITE

410/411
Non-Insulated Insulated

Traditional Raised Panel

Constructed of top quality materials, highly detailed raised panel, deep woodgrain texture, and two coat prefinished paint system all combine to enhance the beauty of your home.

- ◆ 24 gauge steel
- ◆ 1.0 mil paint with 7 color options
- ◆ 8 window options
- ◆ R-value 6.85 *411 Feature
- ◆ Vinyl interior skin *411 Feature

*Colors may vary from actual product

SANDSTONE - SHERWOOD WINDOW

Black

Charcoal

Brown

Sandstone

Desert Tan

Almond

White

doorLink
MANUFACTURING, INC.®

410/411 | Traditional Raised Panel

Non-Insulated

Insulated

24 GAUGE

Features

24 24 GAUGE STEEL

Hot dipped galvanized steel construction with hemmed inside return rail provides superior strength and durability.

ROLLED SAFETY EDGES ON SECTION JOINTS

Eliminates sharp edges, and provides extra strength.

19 GAUGE HOT DIPPED GALVANIZED STILES

Heavy duty metal stiles give strong rigid support for all hinges, rollers, and operator attachment.

STILES ATTACHED WITH RIVETS

Provides superior strength when compared to common sheet metal joining methods.

TONGUE AND GROOVE MEETING RAILS

For superior strength and better sealing against wind, rain, and snow.

RIGID ALUMINUM RETAINER WITH WEATHERSTRIP

Provides added strength while securing replaceable U-type bottom astragal weatherstrip to help keep the elements out.

R-VALUE 6.85

Enhances your home's energy savings, makes your door operation quieter, and reduces exterior noise in your garage. *411 Feature

HIGH IMPACT PLASTIC BACK COVER

Protects the insulation, and enhances the interior look of your garage door. *411 Feature

CFC FREE EXPANDED POLYSTYRENE

Environmentally friendly insulation that will not degrade with vibration or time. *411 Feature

Window Options



- #306 Sherwood
- #305 Williamsburg
- #591 Cascade
- #393 Cathedral
- #397 Stockton
- #597 Stockbridge
- #320 Waterton
- #897 Prairie

Window Glass Options

See website for glass options

*Not all glazing options may be available from all distributors. No glazing on 18" sections

Paint System



1.0 MIL PAINT SYSTEM

Includes .25 mil rust inhibiting primer and .75 mil exterior top coat that resists fading and chalking, while providing consistent color from panel to panel and more durability.

- 1 Paint - .75 MIL
- 2 Primer - .25 MIL
- 3 Steel
- 4 Primer - .2 MIL
- 5 Paint - .3 MIL

Construction

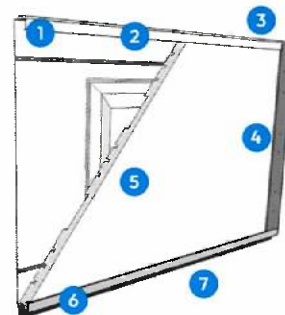

- 1 Tongue and groove meeting rails
- 2 Hemmed interior rails
- 3 2" thick section
- 4 19 gauge hot dipped galvanized steel stiles
- 5 CFC free expanded polystyrene insulation with vinyl backing (standard on 411)
- 6 Replaceable U-Type vinyl bottom weatherstrip
- 7 Extruded aluminum weatherstrip retainer

*This image is showing 411

Size Options

WIDTHS:

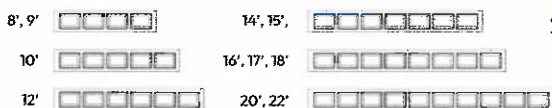

HEIGHTS:

6'6", 6'9", 7'0", 7'6", 7'9", 8'0"

*Contact your distributor for additional heights

420 / 421

NON INSULATED

INSULATED



Short Recessed Panel 24 Gauge

RECESSED PANELS



↑ WHITE

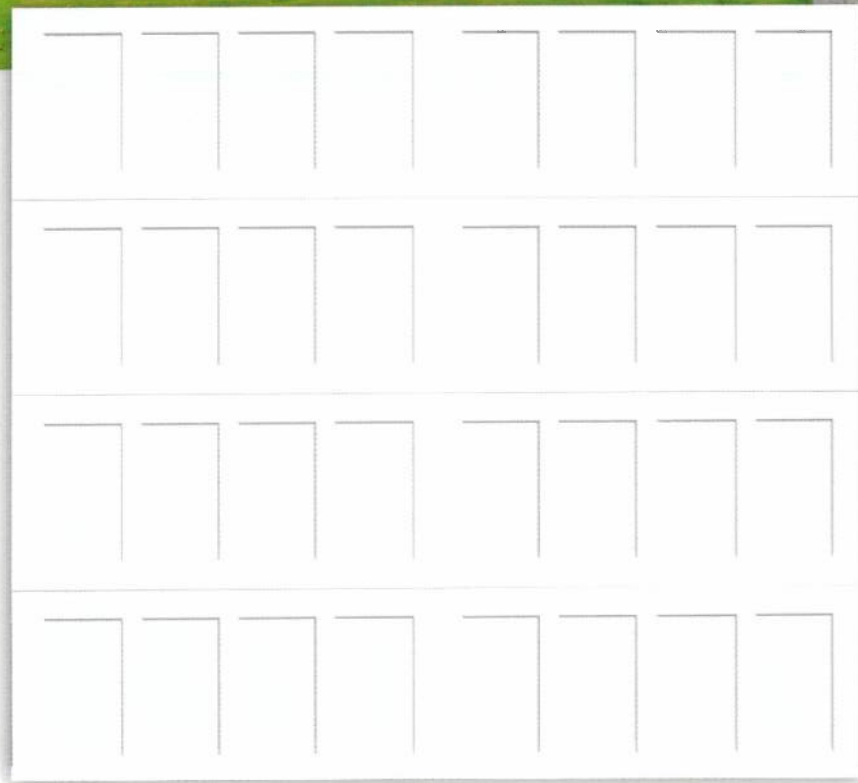

↑ WHITE

Short Recessed Panel

Constructed of top quality materials, highly detailed short recessed panel, deep pebble grain texture, and two coat prefinished paint system all combine to enhance the beauty of your home.

- 24 gauge steel
- 1.0 mil paint with 8 color options
- 6 window options
- R-value 6.85 **421 Feature*
- Vinyl interior skin **421 Feature*



**Colors may vary from actual product*

FEATURES

24 GAUGE STEEL
Hot dipped galvanized steel construction with hemmed inside return rail provides superior strength and durability.

ROLLED SAFETY EDGES ON SECTION JOINTS
Eliminates sharp edges, and provides extra strength.

19 GAUGE HOT DIPPED GALVANIZED STILES
Heavy duty metal stiles give strong rigid support for all hinges, rollers, and operator attachment.

STILES ATTACHED WITH RIVETS
Provides superior strength when compared to common sheet metal joining methods.

TONGUE AND GROOVE MEETING RAILS
For superior strength and better sealing against wind, rain, and snow.

RIGID ALUMINUM RETAINER WITH WEATHERSTRIP
Provides added strength while securing replaceable U-type bottom astragal weatherstrip to help keep the elements out.

DIRECTIONAL WOOD GRAIN PATTERN
Directional wood grain pattern gives the appearance of traditional wood doors.

R-VALUE 6.85
Enhances your home's energy savings, makes your door operation quieter, and reduces exterior noise in your garage.
**421 Feature*

HIGH IMPACT PLASTIC BACK COVER
Protects the insulation, and enhances the interior look of your garage door.
**421 Feature*

CFC FREE EXPANDED POLYSTYRENE
Environmentally friendly insulation that will not degrade with vibration or time.
**421 Feature*

SIZE OPTIONS

WIDTHS:

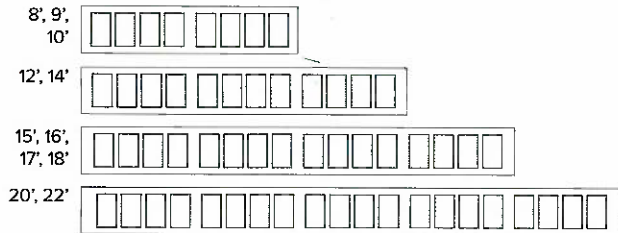

HEIGHTS: 6'6", 6'9", 7'0", 7'6", 7'9", 8'0"

WINDOW OPTIONS

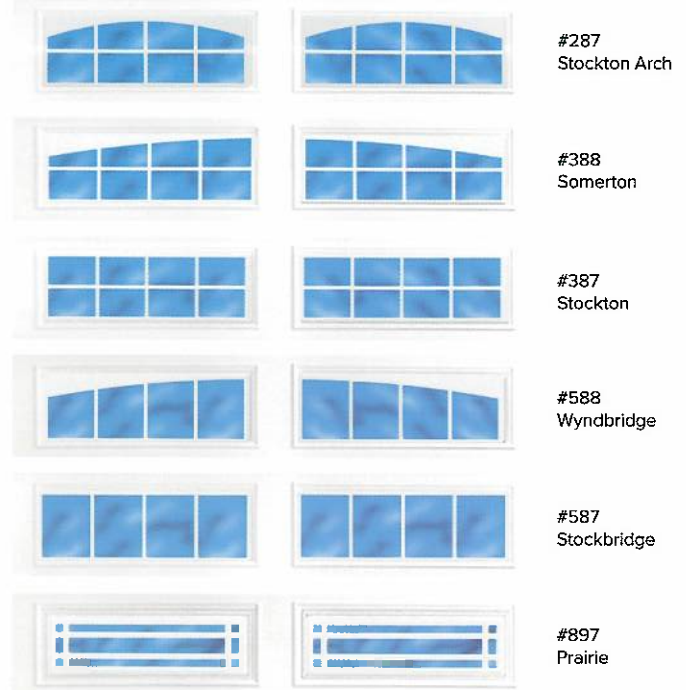

WINDOW GLASS OPTIONS

See website for glass options

**Not all glazing options may be available from all distributors. No glazing on 18" sections. Not all window inserts align with panel stamp design.*

PAINT LAYERS

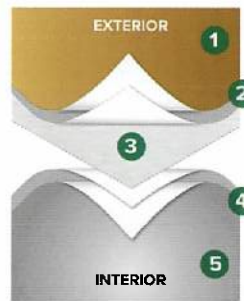

1.0 MIL PAINT SYSTEM

Includes .25 mil rust inhibiting primer and .75 mil exterior top coat that resists fading and chalking, while providing consistent color from panel to panel and more durability.

- 1 Paint - .75 MIL
- 2 Primer - .25 MIL
- 3 Steel
- 4 Primer - .2 MIL
- 5 Paint - .3 MIL

CONSTRUCTION

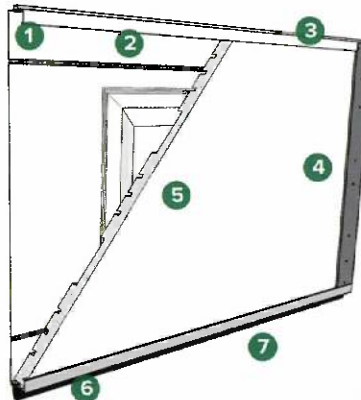

- 1 Tongue and groove meeting rails
- 2 Hemmed interior rails
- 3 2" thick section
- 4 19 gauge hot dipped galvanized steel stiles
- 5 CFC free expanded polystyrene insulation with vinyl backing (standard on 421)
- 6 Replaceable U-Type vinyl bottom weatherstrip
- 7 Extruded aluminum weatherstrip retainer

**This image is showing 421*

430 431

NON INSULATED INSULATED

doorLink

Manufacturing, Inc.®

Grooved Panel 24 Gauge

CARRIAGE HOUSE PANELS

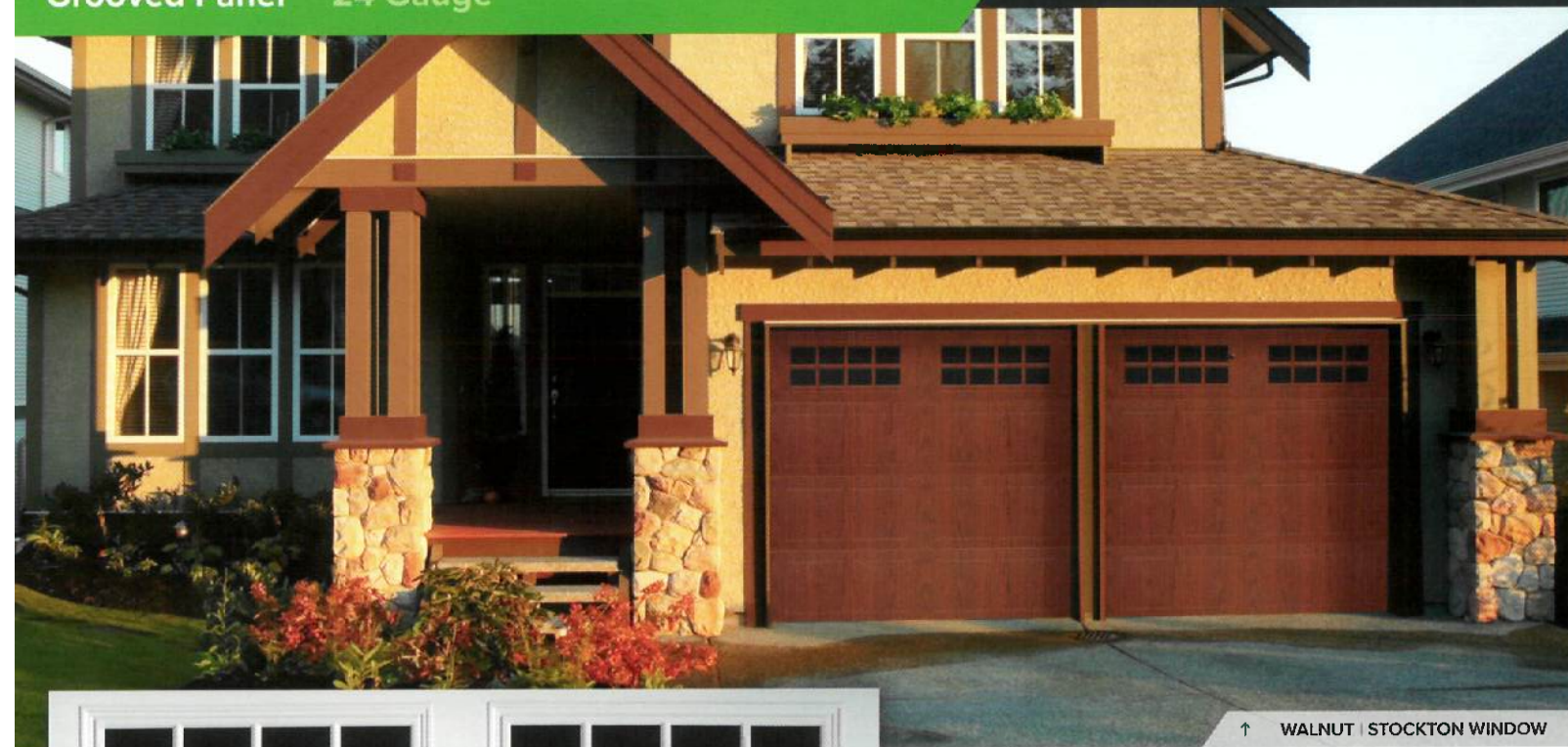

↑ WALNUT | STOCKTON WINDOW



↑ WHITE | STOCKTON WINDOW

Grooved Panel

Constructed of top quality materials, highly detailed grooved panel, deep pebble grain texture, and two coat prefinished paint system all combine to enhance the beauty of your home.

- 24 gauge steel
- 1.0 mil paint with 9 color options
- 6 window options
- R-value 6.85 *431 Feature
- Vinyl interior skin *431 Feature



WHITE



ALMOND



DESERT TAN



SANDSTONE



BROWN



GRAY



BLACK



WALNUT



DRIFTWOOD

*Colors may vary from actual product.

FEATURES

24 24 GAUGE STEEL
Hot dipped galvanized steel construction with hemmed inside return rail provides superior strength and durability.

ROLLED SAFETY EDGES ON SECTION JOINTS
Eliminates sharp edges, and provides extra strength.

19 GAUGE HOT DIPPED GALVANIZED STILES
Heavy duty metal stiles give strong rigid support for all hinges, rollers, and operator attachment.

STILES ATTACHED WITH RIVETS
Provides superior strength when compared to common sheet metal joining methods.

TONGUE AND GROOVE MEETING RAILS
For superior strength and better sealing against wind, rain, and snow.

RIGID ALUMINUM RETAINER WITH WEATHERSTRIP
Provides added strength while securing replaceable U-type bottom astragal weatherstrip to help keep the elements out.

DIRECTIONAL WOOD GRAIN PATTERN
Directional wood grain pattern gives the appearance of traditional wood doors.

R-VALUE 6.85
Enhances your home's energy savings, makes your door operation quieter, and reduces exterior noise in your garage.
**431 Feature*

HIGH IMPACT PLASTIC BACK COVER
Protects the insulation, and enhances the interior look of your garage door. **431 Feature*

CFC FREE EXPANDED POLYSTYRENE
Environmentally friendly insulation that will not degrade with vibration or time. **431 Feature*

SIZE OPTIONS

WIDTHS:

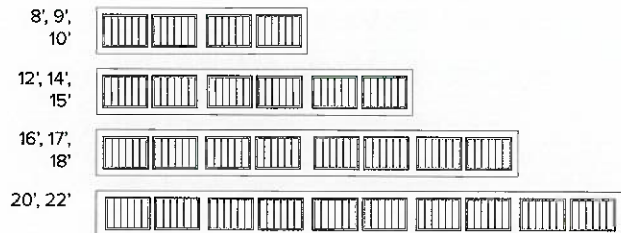

HEIGHTS: 6'6", 6'9", 7'0", 7'6", 7'9", 8'0"

WINDOW OPTIONS



WINDOW GLASS OPTIONS

See website for glass options

**Not all glazing options may be available from all distributors. No glazing on 1B" sections.*

PAINT LAYERS

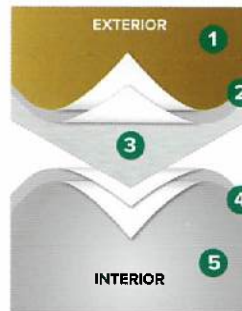

1.0 MIL PAINT SYSTEM

Includes .25 mil rust inhibiting primer and .75 mil exterior top coat that resists fading and chalking, while providing consistent color from panel to panel and more durability.

- 1 Paint - .75 MIL
- 2 Primer - .25 MIL
- 3 Steel
- 4 Primer - .2 MIL
- 5 Paint - .3 MIL

CONSTRUCTION

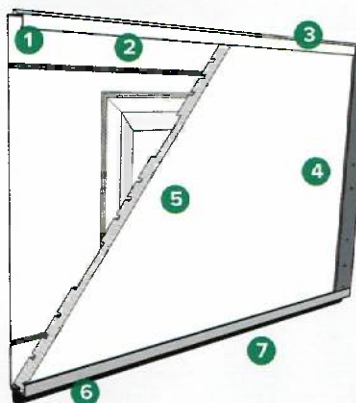

- 1 Tongue and groove meeting rails
- 2 Hemmed interior rails
- 3 2" thick section
- 4 19 gauge hot dipped galvanized steel stiles
- 5 CFC free expanded polystyrene insulation with vinyl backing (standard on 431)
- 6 Replaceable U-Type vinyl bottom weatherstrip
- 7 Extruded aluminum weatherstrip retainer

**This image is showing 431*

440 / 441

NON INSULATED INSULATED

doorLink
Manufacturing, Inc.®

Long Grooved Panel 24 Gauge

CARRIAGE HOUSE PANELS



↑ DESERT TAN | STOCKBRIDGE WINDOW



↑ WHITE | STOCKTON WINDOW

Long Grooved Panel

Constructed of top quality materials, highly detailed long grooved panel, deep pebble grain texture, and two coat prefinished paint system all combine to enhance the beauty of your home.

- 24 gauge steel
- 1.0 mil paint with 8 color options
- 6 window options
- R-value 6.85 **441 Feature*
- Vinyl interior skin **441 Feature*



**Colors may vary from actual product*

FEATURES

24 GAUGE STEEL
Hot dipped galvanized steel construction with hemmed inside return rail provides superior strength and durability.

ROLLED SAFETY EDGES ON SECTION JOINTS
Eliminates sharp edges, and provides extra strength.

19 GAUGE HOT DIPPED GALVANIZED STILES
Heavy duty metal stiles give strong rigid support for all hinges, rollers, and operator attachment.

STILES ATTACHED WITH RIVETS
Provides superior strength when compared to common sheet metal joining methods.

TONGUE AND GROOVE MEETING RAILS
For superior strength and better sealing against wind, rain, and snow.

RIGID ALUMINUM RETAINER WITH WEATHERSTRIP
Provides added strength while securing replaceable U-type bottom astragal weatherstrip to help keep the elements out.

DIRECTIONAL WOOD GRAIN PATTERN
Directional wood grain pattern gives the appearance of traditional wood doors.

R-VALUE 6.85
Enhances your home's energy savings, makes your door operation quieter, and reduces exterior noise in your garage.
**441 Feature*

HIGH IMPACT PLASTIC BACK COVER
Protects the insulation, and enhances the interior look of your garage door. **441 Feature*

CFC FREE EXPANDED POLYSTYRENE
Environmentally friendly insulation that will not degrade with vibration or time. **441 Feature*

SIZE OPTIONS

WIDTHS:

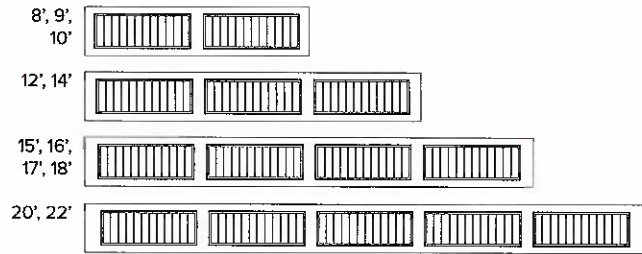

HEIGHTS: 6'6", 6'9", 7'0", 7'6", 7'9", 8'0"

WINDOW OPTIONS

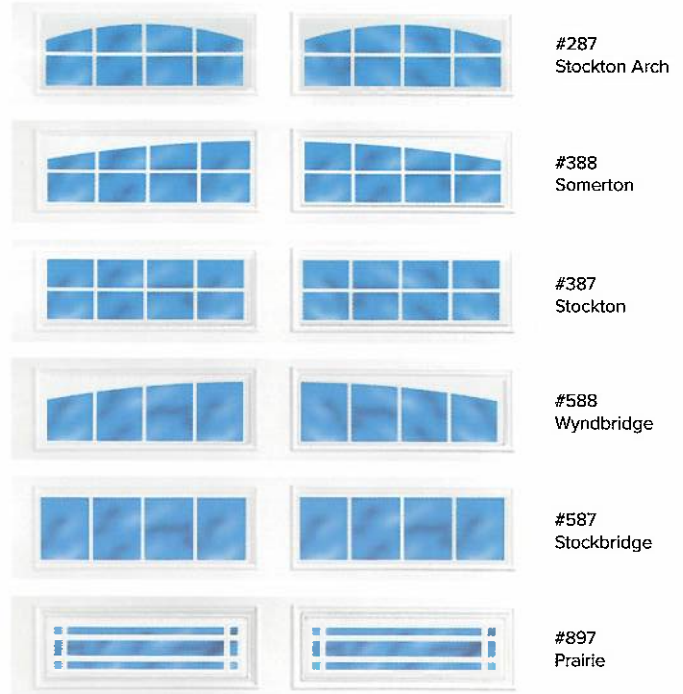

WINDOW GLASS OPTIONS

See website for glass options

**Not all glazing options may be available from all distributors. No glazing on 18" sections.*

PAINT LAYERS

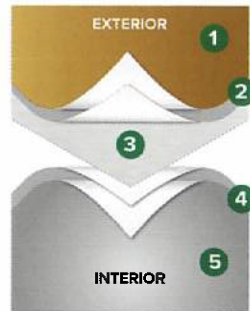

1.0 MIL PAINT SYSTEM

Includes .25 mil rust inhibiting primer and .75 mil exterior top coat that resists fading and chalking, while providing consistent color from panel to panel and more durability.

- 1 Paint - .75 MIL
- 2 Primer - .25 MIL
- 3 Steel
- 4 Primer - .2 MIL
- 5 Paint - .3 MIL

CONSTRUCTION

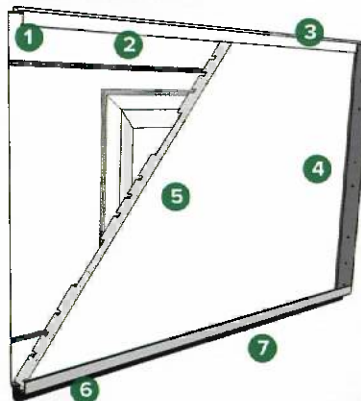

- 1 Tongue and groove meeting rails
- 2 Hemmed interior rails
- 3 2" thick section
- 4 19 gauge hot dipped galvanized steel stiles
- 5 CFC free expanded polystyrene insulation with vinyl backing (standard on 441)
- 6 Replaceable U-Type vinyl bottom weatherstrip
- 7 Extruded aluminum weatherstrip retainer

**This image is showing 441*

Flush Panel

24 GAUGE

450/451

Non-insulated

Insulated

doorLink

MANUFACTURING, INC.®

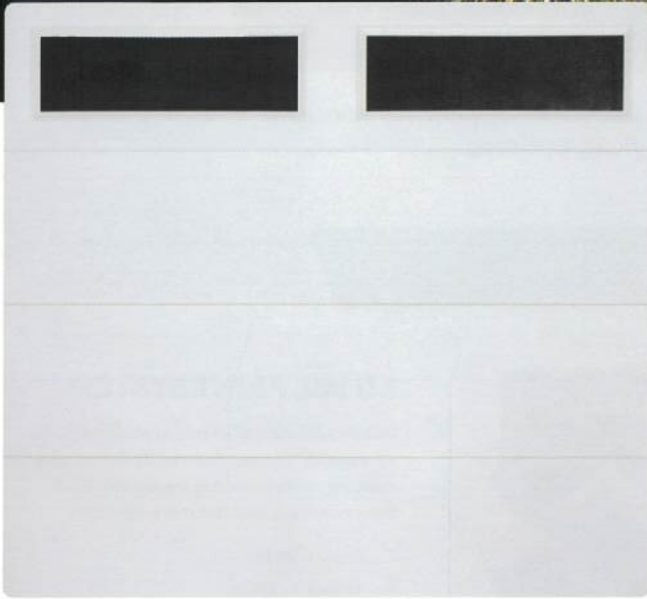

WHITE



WHITE - PLAIN WINDOW

450/451

Non-insulated

Insulated

Flush Panel

Constructed of top quality materials, flush panel with deep woodgrain texture, and two coat prefinished paint system all combine to enhance the beauty of your home.

- ◆ 24 gauge steel
- ◆ 1.0 mil paint with 7 color options
- ◆ R-value 6.85 *451 Feature
- ◆ Vinyl interior skin *451 Feature

- Black
- Charcoal
- Brown
- Sandstone
- Desert Tan
- Almond
- White

doorLink

MANUFACTURING, INC.®

*Colors may vary from actual product

450/451 | Flush Panel

Non-Insulated

Insulated

24 GAUGE

Features

24 24 GAUGE STEEL



Hot dipped galvanized steel construction with hemmed inside return rail provides superior strength and durability.

ROLLED SAFETY EDGES ON SECTION JOINTS



Eliminates sharp edges, and provides extra strength.

19 GAUGE HOT DIPPED GALVANIZED STILES



Heavy duty metal stiles give strong rigid support for all hinges, rollers, and operator attachment.

STILES ATTACHED WITH RIVETS



Provides superior strength when compared to common sheet metal joining methods.

TONGUE AND GROOVE MEETING RAILS



For superior strength and better sealing against wind, rain, and snow.

RIGID ALUMINUM RETAINER WITH WEATHERSTRIP



Provides added strength while securing replaceable U-type bottom astragal weatherstrip to help keep the elements out.

R-VALUE 6.85



Enhances your home's energy savings, makes your door operation quieter, and reduces exterior noise in your garage. *451 Feature

HIGH IMPACT PLASTIC BACK COVER



Protects the insulation, and enhances the interior look of your garage door. *451 Feature

CFC FREE EXPANDED POLYSTYRENE



Environmentally friendly insulation that will not degrade with vibration or time. *451 Feature

Size Options

WIDTHS: 8', 9', 10', 12', 14', 15', 16', 17', 18', 14', 20', 22'

HEIGHTS: 6'6", 6'9", 7'0", 7'6", 7'9", 8'0"

*Contact your distributor for additional heights

Window & Glass Options

Contact your supplier for window and glass options.

Paint System



1.0 MIL PAINT SYSTEM

Includes .25 mil rust inhibiting primer and .75 mil exterior top coat that resists fading and chalking, while providing consistent color from panel to panel and more durability.

- 1 Paint - .75 MIL
- 2 Primer - .25 MIL
- 3 Steel
- 4 Primer - .2 MIL
- 5 Paint - .3 MIL

Construction

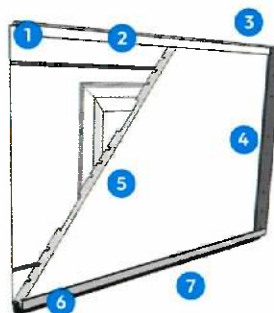

- 1 Tongue and groove meeting rails
- 2 Hemmed interior rails
- 3 2" thick section
- 4 19 gauge hot dipped galvanized steel stiles
- 5 CFC free expanded polystyrene insulation with vinyl backing (standard on 451)
- 6 Replaceable U-Type vinyl bottom weatherstrip
- 7 Extruded aluminum weatherstrip retainer

*This image is showing 451

Louvered Panel

24 GAUGE

460/461

Non-insulated

Insulated

doorLink

MANUFACTURING, INC.®



WHITE



SANDSTONE - PLAIN WINDOW

460/461

Non-insulated

Insulated

Louvered Panel

Constructed of top quality materials, highly detailed louvered panel, deep woodgrain texture, and two coat prefinished paint system all combine to enhance the beauty of your home.

- ◆ 24 gauge steel
- ◆ 1.0 mil paint with 7 color options
- ◆ 6 window options
- ◆ R-value 6.85 *461 Feature
- ◆ Vinyl interior skin *461 Feature

- Black
- Charcoal
- Brown
- Sandstone
- Desert Tan
- Almond
- White

*Colors may vary from actual product

doorLink

MANUFACTURING, INC.®

460/461 | Louvered Panel

Non-insulated

insulated

24 GAUGE

Features



24 24 GAUGE STEEL

Hot dipped galvanized steel construction with hemmed inside return rail provides superior strength and durability.



ROLLED SAFETY EDGES ON SECTION JOINTS

Eliminates sharp edges, and provides extra strength.



19 GAUGE HOT DIPPED GALVANIZED STILES

Heavy duty metal stiles give strong rigid support for all hinges, rollers, and operator attachment.



STILES ATTACHED WITH RIVETS

Provides superior strength when compared to common sheet metal joining methods.



TONGUE AND GROOVE MEETING RAILS

For superior strength and better sealing against wind, rain, and snow.



RIGID ALUMINUM RETAINER WITH WEATHERSTRIP

Provides added strength while securing replaceable U-type bottom astragal weatherstrip to help keep the elements out.



R-VALUE 6.85

Enhances your home's energy savings, makes your door operation quieter, and reduces exterior noise in your garage. *461 Feature



HIGH IMPACT PLASTIC BACK COVER

Protects the insulation, and enhances the interior look of your garage door. *461 Feature



CFC FREE EXPANDED POLYSTYRENE

Environmentally friendly insulation that will not degrade with vibration or time. *461 Feature

Size Options

WIDTHS:



HEIGHT: 6'6", 6'9", 7'0", 7'6", 7'9", 8'0"

*Contact your distributor for additional heights.

Window Options



#287 Stockton Arch



#388 Somerton



#387 Stockton



#588 Wyndbridge



#587 Stockbridge



#897 Prairie

Window Glass Options

See website for glass options

*Not all glazing options may be available from all distributors. No glazing on 18" sections

Paint System



1.0 MIL PAINT SYSTEM

Includes .25 mil rust inhibiting primer and .75 mil exterior top coat that resists fading and chalking, while providing consistent color from panel to panel and more durability.

- 1 Paint - .75 MIL
- 2 Primer - .25 MIL
- 3 Steel
- 4 Primer - .2 MIL
- 5 Paint - .3 MIL

Construction

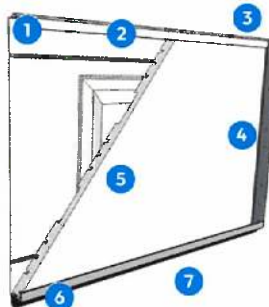

- 1 Tongue and groove meeting rails
- 2 Hemmed interior rails
- 3 2" thick section
- 4 19 gauge hot dipped galvanized steel stiles
- 5 CFC free expanded polystyrene insulation with vinyl backing (standard on 461)
- 6 Replaceable U-Type vinyl bottom weatherstrip
- 7 Extruded aluminum weatherstrip retainer

*This image is showing 461

480 / 481

NON INSULATED INSULATED

doorLink
Manufacturing, Inc.®

Long Recessed Panel 24 Gauge

RECESSED PANELS



↑ GRAY

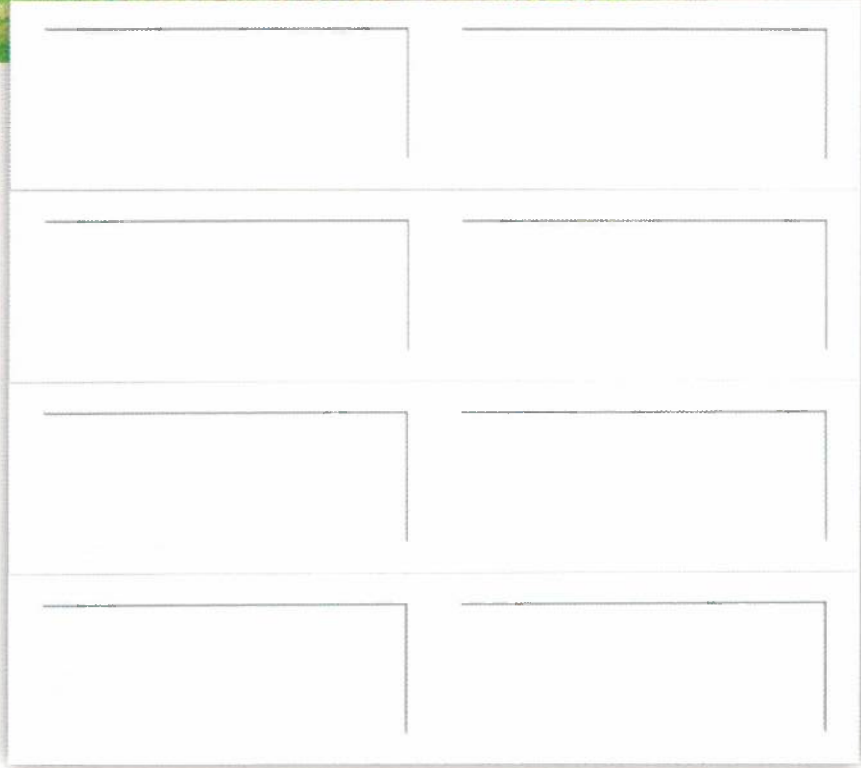

↑ WHITE

Long Recessed Panel

Constructed of top quality materials, highly detailed long recessed panel, deep pebble grain texture, and two coat prefinished paint system all combine to enhance the beauty of your home.

- 24 gauge steel
- 1.0 mil paint with 8 color options
- 6 window options
- R-value 6.85 *481 Feature
- Vinyl interior skin *481 Feature



WHITE ALMOND DESERT TAN SANDSTONE BROWN GRAY BLACK WALNUT

**Colors may vary from actual product*

FEATURES



24 GAUGE STEEL

Hot dipped galvanized steel construction with hemmed inside return rail provides superior strength and durability.



ROLLED SAFETY EDGES ON SECTION JOINTS

Eliminates sharp edges, and provides extra strength.



19 GAUGE HOT DIPPED GALVANIZED STILES

Heavy duty metal stiles give strong rigid support for all hinges, rollers, and operator attachment.



STILES ATTACHED WITH RIVETS

Provides superior strength when compared to common sheet metal joining methods.



TONGUE AND GROOVE MEETING RAILS

For superior strength and better sealing against wind, rain, and snow.



RIGID ALUMINUM RETAINER WITH WEATHERSTRIP

Provides added strength while securing replaceable U-type bottom astragal weatherstrip to help keep the elements out.



DIRECTIONAL WOOD GRAIN PATTERN

Directional wood grain pattern gives the appearance of traditional wood doors.



R-VALUE 6.85

Enhances your home's energy savings, makes your door operation quieter, and reduces exterior noise in your garage.

**481 Feature*



HIGH IMPACT PLASTIC BACK COVER

Protects the insulation, and enhances the interior look of your garage door.

**481 Feature*



CFC FREE EXPANDED POLYSTYRENE

Environmentally friendly insulation that will not degrade with vibration or time.

**481 Feature*

SIZE OPTIONS

WIDTHS:

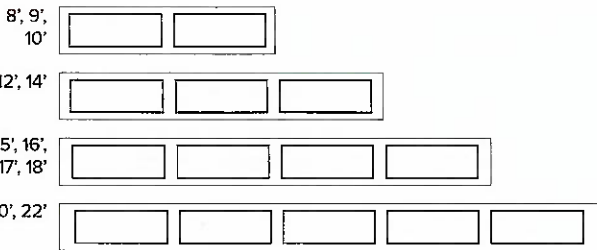

HEIGHTS: 6'6", 6'9", 7'0", 7'6", 7'9", 8'0"

WINDOW OPTIONS

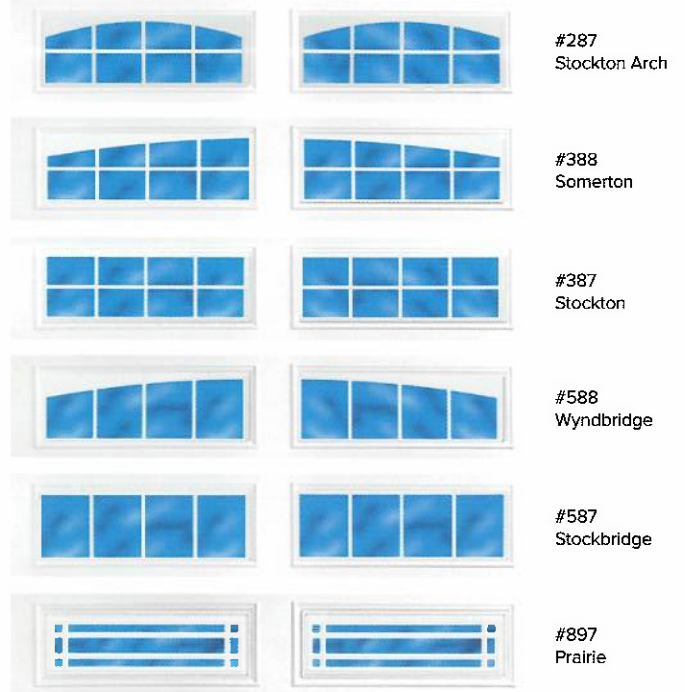

WINDOW GLASS OPTIONS

See website for glass options

**Not all glazing options may be available from all distributors. No glazing on 18" sections.*

PAINT LAYERS



1.0 MIL PAINT SYSTEM

Includes .25 mil rust inhibiting primer and .75 mil exterior top coat that resists fading and chalking, while providing consistent color from panel to panel and more durability.

- 1 Paint - .75 MIL
- 2 Primer - .25 MIL
- 3 Steel
- 4 Primer - .2 MIL
- 5 Paint - .3 MIL

CONSTRUCTION

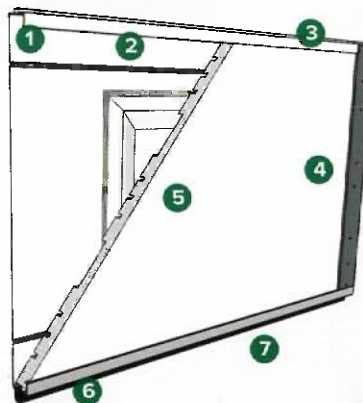

- 1 Tongue and groove meeting rails
- 2 Hemmed interior rails
- 3 2" thick section
- 4 19 gauge hot dipped galvanized steel stiles
- 5 CFC free expanded polystyrene insulation with vinyl backing (standard on 481)
- 6 Replaceable U-Type vinyl bottom weatherstrip
- 7 Extruded aluminum weatherstrip retainer

**This image is showing 481*

**Traditional
Raised Panel**
25 GAUGE

510/511
Non-insulated Insulated

doorLink
MANUFACTURING, INC. *

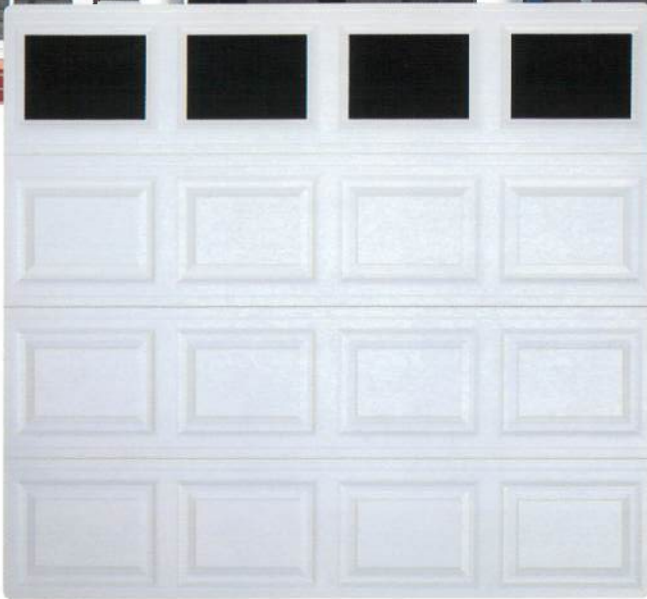

WHITE



SANDSTONE - NO WINDOW

510/511
Non-insulated Insulated

Traditional Raised Panel

Constructed of top quality materials, highly detailed raised panel, deep woodgrain texture, and two coat prefinished paint system all combine to enhance the beauty of your home.

- ◆ 25 gauge steel
- ◆ 1.0 mil paint with 3 color options
- ◆ 8 window options
- ◆ R-value 6.85 *511 Feature
- ◆ Vinyl interior skin *511 Feature

*Colors may vary from actual product



Sandstone



Almond



White

doorLink
MANUFACTURING, INC. *

510/511 | Traditional Raised Panel

Non-insulated

Insulated

25 GAUGE

Features



25 GAUGE STEEL

Hot dipped galvanized steel construction with hemmed inside return rail provides superior strength and durability.



ROLLED SAFETY EDGES ON SECTION JOINTS

Eliminates sharp edges, and provides extra strength.



19 GAUGE HOT DIPPED GALVANIZED STILES

Heavy duty metal stiles give strong rigid support for all hinges, rollers, and operator attachment.



STILES ATTACHED WITH RIVETS

Provides superior strength when compared to common sheet metal joining methods.



TONGUE AND GROOVE MEETING RAILS

For superior strength and better sealing against wind, rain, and snow.



RIGID ALUMINUM RETAINER WITH WEATHERSTRIP

Provides added strength while securing replaceable U-type bottom astragal weatherstrip to help keep the elements out.



6.85

R-VALUE 6.85

Enhances your home's energy savings, makes your door operation quieter, and reduces exterior noise in your garage. *511 Feature



HIGH IMPACT PLASTIC BACK COVER

Protects the insulation, and enhances the interior look of your garage door. *511 Feature



CFC FREE EXPANDED POLYSTYRENE

Environmentally friendly insulation that will not degrade with vibration or time. *511 Feature

Size Options

WIDTHS:

8', 9'		14', 15'	
10'		16', 17', 18'	
12'		HEIGHTS: 6'6", 6'9", 7'0", 7'6", 7'9", 8'0"	

*Contact your distributor for additional heights.

Window Options



#306 Sherwood



#305 Williamsburg



#591 Cascade



#393 Cathedral



#397 Stockton



#597 Stockbridge



#320 Waterton



#897 Prairie

Window Glass Options

See website for glass options

*Not all glazing options may be available from all distributors. No glazing on 18" sections

Paint System



1.0 MIL PAINT SYSTEM

Includes .25 mil rust inhibiting primer and .75 mil exterior top coat that resists fading and chalking, while providing consistent color from panel to panel and more durability.

- 1 Paint - .75 MIL
- 2 Primer - .25 MIL
- 3 Steel
- 4 Primer - .2 MIL
- 5 Paint - .3 MIL

Construction

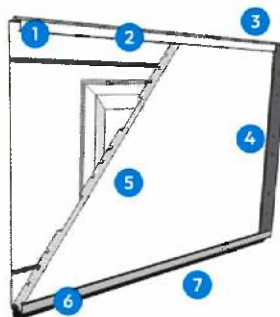

- 1 Tongue and groove meeting rails
- 2 Hemmed interior rails
- 3 2" thick section
- 4 19 gauge hot dipped galvanized steel stiles
- 5 CFC free expanded polystyrene insulation with vinyl backing (standard on 511)
- 6 Replaceable U-Type vinyl bottom weatherstrip
- 7 Extruded aluminum weatherstrip retainer

*This image is showing 511

**Raised Ranch
Panel**
25 GAUGE

590/591
Non-insulated Insulated

doorLink
MANUFACTURING, INC. *



WHITE

590/591
Non-insulated Insulated

Raised Ranch Panel

Constructed of top quality materials, highly detailed louvered panel, deep woodgrain texture, and two coat prefinished paint system all combine to enhance the beauty of your home.

- ◆ 25 gauge steel
- ◆ 1.0 mil paint with 3 color options
- ◆ 6 window options
- ◆ R-value 6.85 *591 Feature
- ◆ Vinyl interior skin *591 Feature

*Colors may vary from actual product



WHITE - SHERWOOD WINDOW

Almond

Sandstone

White

doorLink
MANUFACTURING, INC. *

590/591 | Raised Ranch Panel

Non-Insulated

Insulated

25 GAUGE

Features

25 25 GAUGE STEEL

Hot dipped galvanized steel construction with hemmed inside return rail provides superior strength and durability.

ROLLED SAFETY EDGES ON SECTION JOINTS

Eliminates sharp edges, and provides extra strength.

19 GAUGE HOT DIPPED GALVANIZED STILES

Heavy duty metal stiles give strong rigid support for all hinges, rollers, and operator attachment.

STILES ATTACHED WITH RIVETS

Provides superior strength when compared to common sheet metal joining methods.

TONGUE AND GROOVE MEETING RAILS

For superior strength and better sealing against wind, rain, and snow.

RIGID ALUMINUM RETAINER WITH WEATHERSTRIP

Provides added strength while securing replaceable U-type bottom astragal weatherstrip to help keep the elements out.

R-VALUE 6.85

Enhances your home's energy savings, makes your door operation quieter, and reduces exterior noise in your garage. **591 Feature*

HIGH IMPACT PLASTIC BACK COVER

Protects the insulation, and enhances the interior look of your garage door. **591 Feature*

CFC FREE EXPANDED POLYSTYRENE

Environmentally friendly insulation that will not degrade with vibration or time. **591 Feature*

Size Options

WIDTHS:



HEIGHTS: 6'6", 6'9", 7'0", 7'6", 7'9", 8'0"

**Contact your distributor for additional heights.*

Window Options



#306
Sherwood



#305
Williamsburg



#591
Cascade



#397
Stockton



#597
Stockbridge



#897
Prairie

Window Glass Options

See website for glass options

**Not all glazing options may be available from all distributors. No glazing on 18" sections*

Paint System



1.0 MIL PAINT SYSTEM

Includes .25 mil rust inhibiting primer and .75 mil exterior top coat that resists fading and chalking, while providing consistent color from panel to panel and more durability.

- 1 Paint - .75 MIL
- 2 Primer - .25 MIL
- 3 Steel
- 4 Primer - .2 MIL
- 5 Paint - .3 MIL

Construction

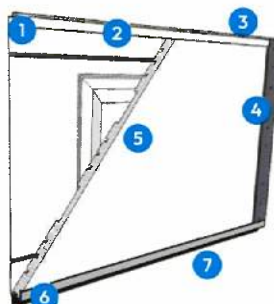

- 1 Tongue and groove meeting rails
- 2 Hemmed interior rails
- 3 2" thick section
- 4 19 gauge hot dipped galvanized steel stiles
- 5 CFC free expanded polystyrene insulation with vinyl backing (standard on 591)
- 6 Replaceable U-Type vinyl bottom weatherstrip
- 7 Extruded aluminum weatherstrip retainer

**This image is showing 591*